

INSTALLATION DE PYZO

Pour installer Pyzo et retrouver l'environnement de travail du lycée, aller sur le lien : <https://pyzo.org/start.html>

⇒ **Step 1** : télécharger la dernière version de **Pyzo** adaptée à votre ordinateur et système d'exploitation sur le lien :



Getting started with Pyzo

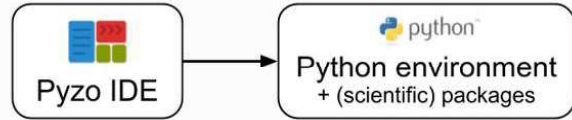

To get started with Pyzo, you need to install the Pyzo IDE (in which you write your code) and a Python environment (in which you run your code).

Step 1: install the Pyzo IDE

Most users can select one of these:

- Windows: Pyzo installer (64bit)
- macOS: Pyzo dmg (macOS 10.13 High Sierra or higher)
- Linux: Pyzo tarball (build on Ubuntu 18.04, 64bit).



Otherwise, see all releases for more downloads (e.g. 32/64 bit Windows zipfiles, and older versions). Linux users can also install Pyzo using Linux system packages. See the installation page for more information.

⇒ **Step 2** : télécharger la version 3.7 de **Miniconda** adaptée à votre ordinateur et système d'exploitation sur le lien :



Step 2: install Python environment

To run Python code, you need a Python interpreter. Pyzo works with most Python interpreters. If you're not sure what to use, don't worry, you can install multiple environments side-by-side, and use each one from Pyzo. Just make sure to use Python 3 (not Python 2).

We recommend starting with either of these:

- The regular Python. Additional packages can be installed using `pip`.
- The Anaconda distribution comes with a lot of scientific packages. The Miniconda distribution is a lighter version that starts with fewer packages. Additional packages can be installed using `conda` or `pip`.



We recommend installing in the default location, or at least a location that can be written to without admin privileges, so that additional packages can be installed.

⇒ **Step 3** : ouvrir Pyzo et configurer le shell :

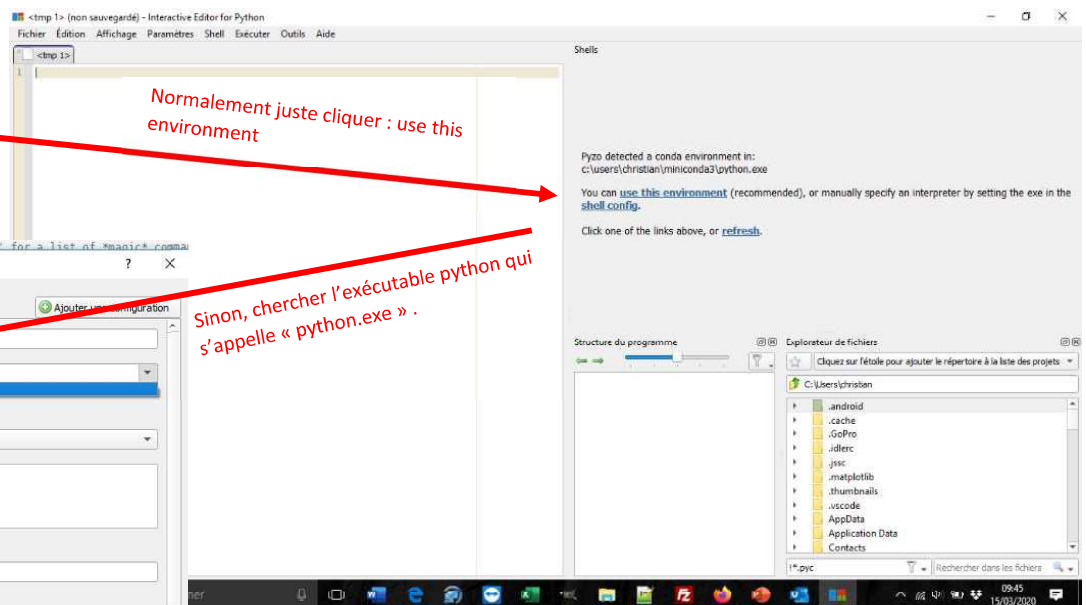

Normalement juste cliquer : use this environment

Sinon, chercher l'exécutable python qui s'appelle « python.exe ».

